

SK-3-M8-NB-VA/PTFE

CS0015

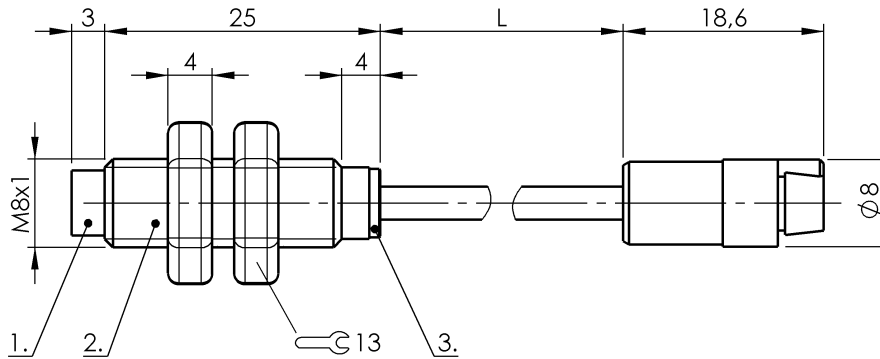

1) Sensing surface 2) Housing 3) Cover



Electrical connection

| | |
|-----------------------------|-------------------------------------|
| Cable length | 2 m |
| Connection | Special connector-Special connector |
| Connection type | Connector with cable, 2.00 m, PUR |
| Polarity reversal protected | not relevant |
| Short-circuit protection | not relevant |

Electrical data

| | |
|--------------------------------|-----------|
| Hysteresis H max. (% of Sr) | 10.0 % |
| MTTF (40 °C) | 1813 a |
| Operating voltage U_b | 4...8 VDC |
| Rated insulation voltage U_i | 75 V DC |
| Repeat accuracy max. (% of Sr) | 2.0 % |
| Switching frequency | 100 Hz |
| Utilization category | DC -13 |

Environmental conditions

| | |
|---------------------------|-------------|
| Ambient temperature | -30...80 °C |
| Ambient temperature max. | 80 °C |
| Ambient temperature min. | -30 °C |
| Protection type IEC 60529 | IP67 |

Functional safety

| | |
|---------------------|-----|
| Diagnostic coverage | 0 % |
| Functional safety | no |

General data

| | |
|---------------------|-------------------------|
| Approval/Conformity | CE cULus |
| Basic standard | IEC 60947-5-2 |
| Scope of delivery | Nut (2x) |
| Sensitivity | adjustable on base unit |

Material

| | |
|--------------------------|--------------------------|
| Cover material | POM |
| Housing material | Stainless steel (1.4301) |
| Material cover | POM |
| Material jacket | PUR |
| Material sensing surface | PTFE |

Mechanical data

| | |
|-------------------|-----------|
| Dimension | undefined |
| Installation | non-flush |
| Size | M8x1 |
| Tightening torque | 6 Nm |

Output/Interface

| | |
|------------------|----------------------------|
| Interface | Special interface |
| Switching output | see signal amplifier (BAE) |

Range/Distance

| | |
|--------------------------------|------------|
| Measuring range | 0.1...3 mm |
| Range | 0.1...3 mm |
| Rated operating distance S_n | 3 mm |
| Ripple max. (% of U_e) | 10 % |