

LION

PRECISION



Be confident when you do
business with Lion Precision.

LION

PRECISION



USER'S GUIDE

for the

LRD900

Photoelectric Sensor Label

Warnings

Sensor body is connected to Ground. Sensors must not be attached to voltages in excess of 30VRMS or 60VDC. Use of the equipment in any other manner may impair the safety and EMI protections of the equipment. All power must be off when installing the sensor.

Specifications

Power Supply	Voltage	10-30 VDC $\overline{=}$ (reverse polarity protected)
	Current	<40mA
Response time	on or off	50 μ s Max
	Switching Frequency	10kHz Max
Output	Output Current (sinking or sourcing)	200mA Max (overload protected)
	Switching Output	PNP (sourcing) or NPN (sinking) w/ Dark or light switching
Temperature	Operating Range	32°F - 140°F (-4°C...+60°C)

Dimensions

Side view

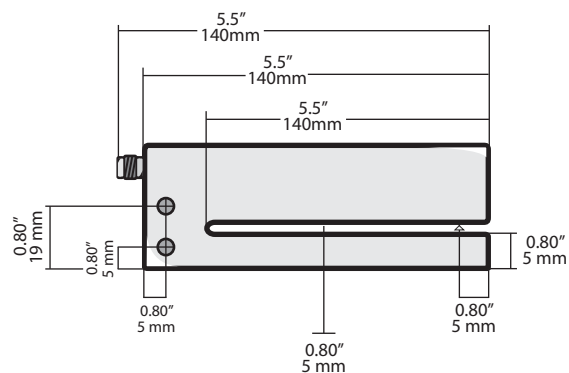

Front view

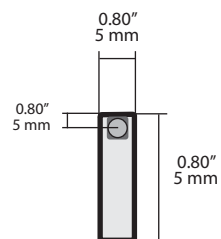

LRD900 Wiring

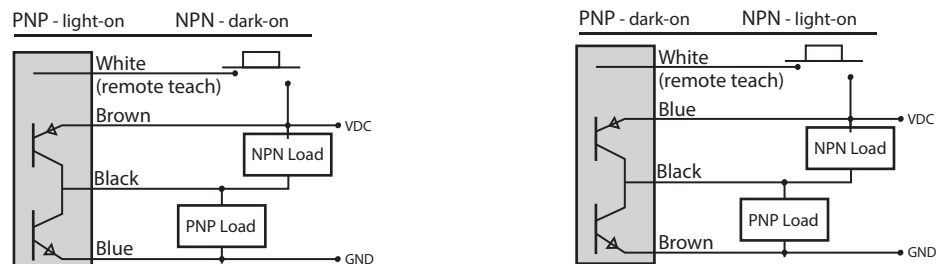

Adjusting the LRD 900

The Lion Precision LRD900 Label Sensor uses LED optical technology to sense label edges for registration, counting and other applications.

Step 1

Remove a label from the web. Place the area of the missing label in the sensor - (liner only).

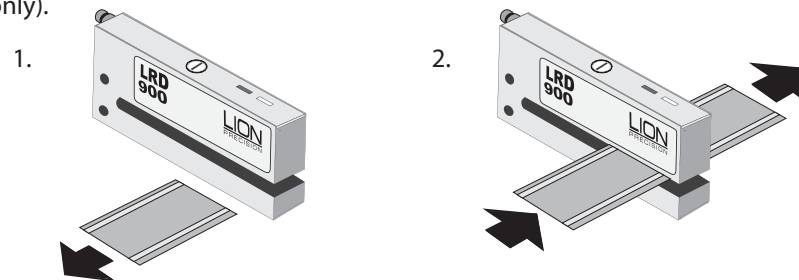

Step 2

Turn potentiometer to the LEFT until the red LED appears.

Red LED is on with label present

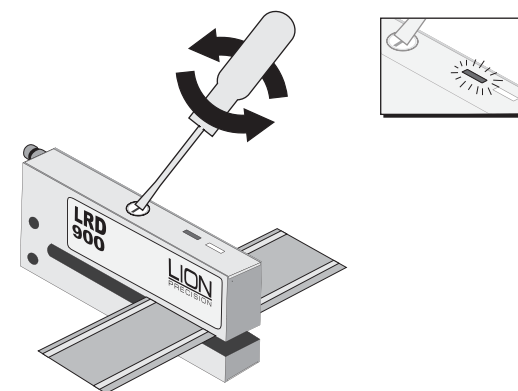

Step 3

Turn potentiometer to the RIGHT until the green LED appears.

Green LED is on without label present

Turn potentiometer 1 to 3 rotations farther to the right depending on the contrast between backing and label.

