

# SK1-FSA-M18-NNBS-PVC-Y1 CS008W

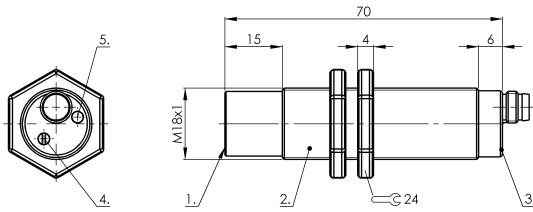

Connector view

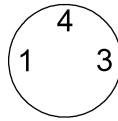

Wiring Diagram

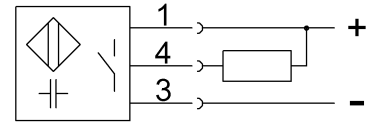

1) Sensing surface 2) Housing 3) Cover 4) Potentiometer 5) LED function indicator



## Electrical connection

Connection	M8x1-Connector, 3-pole
Polarity reversal protected	yes
Short-circuit protection	yes

## Electrical data

MTTF (40 °C)	239 a
Operating voltage $U_b$	10...35 VDC
Protected against miswiring	yes
Rated insulation voltage $U_i$	75 V DC
Rated operating current $I_e$ DC	300 mA
Ready delay $t_v$ max.	300 ms
Switching frequency	2 Hz
Utilization category	DC-13
Voltage drop static max.	1.8 V

## Environmental conditions

Ambient temperature	-10...60 °C
Protection type IEC 60529	IP66 IP64 at connector output

## Functional safety

Diagnostic coverage	0 %
Functional safety	no

## General data

Approval/Conformity	CE cULus
Basic standard	IEC 60947-5-2
Scope of delivery	Nut (2x)

Sensitivity  
Series

media-dependent, adjustable  
Level sensor

## Material

Cover material	PVC
Housing material	PVC
Material cover	PVC
Material sensing surface	PVC

## Mechanical data

Dimension	undefined
Installation	non-flush
Size	M18x1
Tightening torque	1 Nm

## Output/Interface

Switching output	NPN Normally open (NO)
------------------	------------------------

## Range/Distance

Ripple max. (% of $U_e$ )	10 %
---------------------------	------

## Remarks

Note for using in standard applications with aqueous media: The Smart Level sensors are factory adjusted for standard applications. With this setting the Smart Level sensors can be used without further adjustment for detecting aqueous media through glass or plastic walls. The factory setting can automatically mask glass or plastic walls (approx. 0.5 mm to 6 mm) and compensate for foam, moisture and dirt buildup inside and outside the container. Special applications: The Smart Level sensors can also be used with