

SK1-30-M30-NNBX-PBT-Y2

CS007H

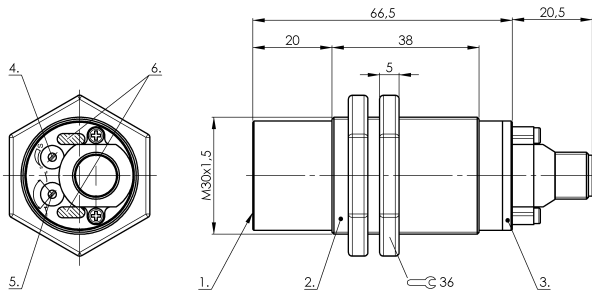

Connector view

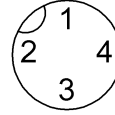

Wiring Diagram



1) Sensing surface 2) Housing 3) Cover 4) Potentiometer 5) NO or NC selectable 6) LED function indicator



Display/Operation

Function indicator	yes
Power indicator	yes

Electrical connection

Connection	M12x1-Connector, 4-pole, A-coded
Polarity reversal protected	yes
Short-circuit protection	yes

Electrical data

Hysteresis H max. (% of Sr)	15.0 %
MTTF (40 °C)	455 a
Operating voltage Ub	10...35 VDC
Protected against miswiring	yes
Rated insulation voltage Ui	75 V DC
Rated operating current Ie DC	300 mA
Repeat accuracy max. (% of Sr)	5.0 %
Switching frequency	100 Hz
Utilization category	DC -13
Voltage drop static max.	1.8 V

Environmental conditions

Ambient temperature	-30...70 °C
Protection type IEC 60529	IP66 IP64 at connector output

Functional safety

Diagnostic coverage	0 %
Functional safety	no

General data

Approval/Conformity	CE cULus
Basic standard	IEC 60947-5-2
Scope of delivery	Nut (2x)

Material

Cover material	PBT PE
Housing material	PBT
Material cover	PBTPE
Material sensing surface	PBT

Mechanical data

Dimension	undefined
Installation	non-flush
Size	M30x1.5
Tightening torque	4 Nm

Output/Interface

Switching output	NPN Normally open/Normally closed (NO/NC)
------------------	---

Range/Distance

Measuring range	1...30 mm
Range	1...30 mm
Rated operating distance Sn	30 mm
Ripple max. (% of Ue)	10 %
Temperature drift max. (% of Sr)	15 %